

**CITY OF PALM BEACH GARDENS
CITY COUNCIL
Agenda Cover Memorandum**

**Meeting Date: April 7, 2016
Resolution 21, 2016**



SUBJECT/AGENDA ITEM

Compassionate Friends Memorial Garden at Burns Road Community Center – Art in Public Places (AIPP)

Public Hearing and Consideration for Approval: A City-initiated request to approve an AIPP-funded project for the Compassionate Friends Memorial Garden at the City's Burns Road Community Center property located on Burns Road and Military Trail.

Recommendation to APPROVE

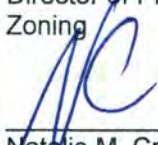
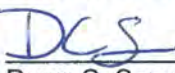
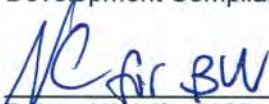
Recommendation to DENY

<p>Reviewed by: Director of Planning & Zoning  Natalie M. Crowley, AICP</p>	<p>Originating Dept.: Planning & Zoning: Project Manager  Dawn C. Sonneborn, AICP, Principal Planner</p>	<p>Finance: Accountant Tresha Thomas Fees Paid: <u>N/A</u></p>	<p>Council Action: <input type="checkbox"/> Approved <input type="checkbox"/> Approved w/ Conditions <input type="checkbox"/> Denied <input type="checkbox"/> Continued to: _____</p>
<p>Development Compliance  Bahareh Wolfs, AICP</p>	<p><input checked="" type="checkbox"/> Quasi – Judicial <input type="checkbox"/> Legislative <input type="checkbox"/> Public Hearing</p>	<p>Funding Source: <input type="checkbox"/> Operating <input checked="" type="checkbox"/> Other <u>AIPP</u></p>	<p>Attachments:</p> <ul style="list-style-type: none"> • Location Map • Project Narrative • Compassionate Friends Mission Information • Site Plan • Cost Estimate • Artwork • Artist's Resume and Works of Art • Resolution 21, 2016
<p>City Attorney  R. Max Lohman, Esq.</p>	<p>Advertised: <input type="checkbox"/> Required <input checked="" type="checkbox"/> Not Required</p>	<p>Budget Acct.#: <u>N/A</u> Contract/Agreement: Effective Date: <u>N/A</u></p>	
<p>Approved By: City Manager  Ronald M. Ferris</p>	<p>Affected parties: <input checked="" type="checkbox"/> Not Required <input type="checkbox"/> Notified</p>	<p>Expiration Date: <u>N/A</u></p>	

EXECUTIVE SUMMARY

A City-initiated request to approve an AIPP-funded project for the Compassionate Friends Memorial Garden with a centrally located public art feature created by local artist Mark Fuller. The memorial garden is proposed to be constructed adjacent to the lake located at the City's Burns Road Community Center property on Burns Road and Military Trail.

BACKGROUND

Representatives of Compassionate Friends within our community approached the City with the request for a memorial garden at the Burns Road Community Center. Compassionate Friends was founded over 40 years ago in England. The Compassionate Friends was established in the United States and incorporated in 1978. Each chapter, along with the supporting National Office, is committed to helping bereaved parents, siblings, or grandparents who have lost a child. The mission of Compassionate Friends is: *When a child dies, at any age, the family suffers intense pain and may feel hopeless and isolated. The Compassionate Friends provides highly personal comfort, hope, and support to every family experiencing the death of a son or a daughter, a brother or a sister, or a grandchild, and helps others better assist the grieving family.*

BUDGET

The estimated budget for the memorial garden and public art is \$159,348.20. The City's current AIPP fund is \$435,815.00.

PROJECT DETAILS

Proposed Art, Location and Surrounding Garden

The City is proposing to construct an artistic memorial garden within the Burns Road Community Center property on the east side of the existing lake. The memorial garden is designed to symbolize the lasting memory of loved ones who have passed away, specifically children. The proposed artistic sculpture is composed of two (2) hands in an open position with an open heart in the center of each palm. Positioned between the two hands is a mirror-polished stainless steel "winged-heart". The gesture of the splayed hands is representative of releasing or setting-free.

The sculpture will be placed on a concrete pedestal and will be six (6)-feet, 10-inches tall with the actual sculpture itself being three (3) feet, six (6) inches tall. The hands are fabricated from formed and welded 0.125-inch aluminum plate with a powder coated gloss-white finish. The dimensional heart and attached wings are fabricated from 16-gauge formed and welded mirror-polished stainless steel.

The sculpture will be centrally located within a brick-paver plaza area with a surrounding seat wall and landscaping that has been designed to create two (2) sub-plaza areas. Several existing horseshoe pits within the proposed area will be relocated to the adjacent northeast open space area within the property.

Artist

Mark Fuller is a well-known local artist and environmental graphic designer that has provided numerous public art pieces in the City of Palm Beach Gardens. He has been involved in the public art forum since 1992.

Lighting

At-grade lighting fixtures and landscape lighting are proposed to accent the sculpture, which will be lit from dusk to midnight, as required by Section 78-262(d).

Landscaping

The plaza is surrounded by a landscape bed, seat wall, pedestrian benches, and a sidewalk connecting to the existing parking lot. The perimeter landscaping includes Montgomery and Coconut Palms that will frame the plaza along with low shrubs and ground cover. A Live Oak is proposed at the center of the plaza in alignment with the sculpture. The pedestrian benches are proposed to be positioned to overlook the existing lake.

Maintenance

Maintenance of the artwork is proposed as an annual or as-needed cleaning by washing and then polishing with a carnauba automotive wax.

ART IN PUBLIC PLACES (AIPP) BOARD

On February 16, 2016, the AIPP Board voted 6 to 0 to recommend approval of the subject petition to the City Council.

STAFF RECOMMENDATION

Staff recommends APPROVAL of Resolution 21, 2016 as presented.

LOCATION MAP







Landscape Architects | Land Planners | Environmental Consultants
1934 Commerce Lane • Suite 1 • Jupiter, Florida • 33458 • Ph 561.747.6336 • Fax 561.747.1377 • www.cotleurhearing.com • Lic # LC-C000239

Compassionate Friends Memorial
Art in Public Places
Justification Statement
January 4, 2016

Introduction

On behalf of the City of Palm Beach Gardens, the Applicant, we are requesting approval of Art in Public Places at the Burns Road Community Center. The project is an artistic memorial is designed to symbolize the lasting memory of our loved ones who have passed away. The Burns Road Community Center is located at the northeast corner of Military Trail and Burns Road.

Project Contact:

Agent/Planner - Cotleur & Hearing

Donaldson Hearing / Kathryn DeWitt

1934 Commerce Lane, Suite 1

Jupiter, FL 33458

Phone: (561) 747- 6336 ext. 102

Fax: (561) 747-1377

Email: dhearing@cotleur-hearing.com

Location

The Burns Road Community Center property is approximately 16 acres and located at the southeast corner of Military Trail and Burns Road. The property contains the City's community center, aquatic center, and open space areas with walking paths and shuffle board courts. The proposed art piece will be located on the western portion of the property, on the east side of the lake.

Land Use & Zoning

The land use designation of the property is Recreational Open Space (ROS). The site is currently zoned Public Institutional with a Planned Unit Development Overlay (P/I / PUD).

Artist

Mark Fuller is an environmental graphic and industrial designer, and has been participating in the Public Art forum since 1992. He is a creator of dynamic site specific exterior public art installations for a wide variety of projects, and has been established in West Palm Beach, Florida since 1986. In his early years as a professional designer, Fuller served as Director of Graphics for a large urban planning firm before relocating to New York City as Senior Project Designer for world-renowned Lance Wyman of Lance Wyman, Ltd. where he honed his design skills to a world-

class level and gained invaluable experiences with top-shelf national and international clients and projects.

Fuller's industrial design experience includes wayfinding systems, urban street furniture such as seating elements, bollards, lighting fixtures, tree grates, and information kiosks. While the style of Fuller's work is not characterized by a specific "look," it is highly stylized by his research into the unique function, architecture, environmental and cultural aspects that surround each project. As a result, the visual characteristics of Fuller's installations flex and change with an appropriate sensitivity for the project at hand. His works are site-specific, and typically laced with symbolic or abstract references that link the art solidly to its environment.

Fuller's Art in Public Places installations have included kinetic constructions, compression-tension cable structures, and static free-standing elements. Recent works have explored the use of cutting edge high-technology and dichroic coatings. His installations have included solar-generated electric power, LED luminaries, and the recycling of various glass waste materials. With an interest to promote "green" and low carbon footprint ideology, Fuller continues to move forward developing appropriate eco-conscious fabrication methods and techniques.

Proposed Art

The City of Palm Beach Gardens is proposing to construct an artistic memorial within the Burns Road Community Center property. The memorial is designed to symbolize the lasting memory of our loved ones who have passed away, specifically children. The sculpture is composed of two hands in an open position. Each hand has the shape of a heart removed from the center of the palm area. Positioned between the two hands is a mirror-polished stainless steel "winged heart" in an animated posture. The gesture of the splayed hands is representative to both a praying gesture as well as the action of releasing something or "setting free." In this context, the viewer immediately creates a visual connection between the hearts, and the message becomes clear: *the heart is set free and a lasting impression or memory of the departed remains.*

The sculpture will be placed on a concrete pedestal and sit 6'10" tall. The hand sculpture itself is 3'6" tall. The hands are fabricated from formed and welded 0.125" aluminum plate with a powder coated gloss white finish. The dimensional heart and attached wings are fabricated from 16 gauge formed and welded mirror-polished stainless steel. These materials are well-suited for the South Florida environment. Maintenance upkeep involves an annual (or as needed) wash and polish application of quality carnuba automotive wax.

Landscape and Hardscape

The art piece will sit on the east side of the existing lake and has been located to align with the existing fountain. This will enhance and contribute to the user experience. A paver plaza area is proposed and has been designed to create two sub plazas within the larger plaza area. The plaza is surrounded by a landscape bed, seat wall, pedestrian benches, and a sidewalk connecting to

Compassionate Friends Memorial
Art in Public Places
AIPP-16-01-000xxx
CH 15-1107
January 4, 2016

the existing parking lot. The perimeter landscaping includes Montgomery Palms and Coconut Palms that will frame the plaza along with low shrubs and ground cover. A Live Oak tree is located at the center of the plaza in alignment with the art piece. The pedestrian benches have been positioned to overlook the lake.

Lighting

At grade lighting fixtures and landscape lights have been proposed for the project to properly accent the art piece. The specific locations will be determined at the time of installation.

Cost Estimates

The project costs have been broken up into separate estimates for hardscape, landscape, and irrigation (see *Cost Estimate* included herein). The total project budget is estimated at \$144,862.08.

Conclusion

The Compassionate Friends Memorial art project is Applicant is requesting AIPP approval for the sculpture to be placed on the Burns Road Community Center Property. The Applicant looks forward to working with Staff to respond to any questions or issues that might arise as a result of your review.



[Contact Us](#) | [Leadership](#) | [Sign Up For National Publications](#) | [En Español](#)

Toll-Free: 877.969.0010
Phone: 630.990.0010

Our Mission

The mission of The Compassionate Friends: *When a child dies, at any age, the family suffers intense pain and may feel hopeless and isolated. The Compassionate Friends provides highly personal comfort, hope, and support to every family experiencing the death of a son or a daughter, a brother or a sister, or a grandchild, and helps others better assist the grieving family.*

The Compassionate Friends was founded over 40 years ago when a chaplain at the Warwickshire Hospital in England brought together two sets of grieving parents and realized that the support they gave each other was better than anything he, as a chaplain, could ever say or provide. Meeting around a kitchen table, the Lawleys and the Hendersons were joined by a bereaved mother and the chaplain, Simon Stephens, and The Society of the Compassionate Friends was born. The Compassionate Friends jumped across the ocean and was established in the United States and incorporated in 1978 in Illinois.

Each chapter, along with the supporting National Office, is committed to helping every bereaved parent, sibling, or grandparent who may walk through our doors or contact us.

Today TCF has about 660 chapters serving all 50 states plus Washington D.C., Puerto Rico, and Guam offer friendship, understanding, and hope to bereaved parents, siblings, grandparents, and other family members during the natural grieving process after a child has died. Around the world more than 30 countries have a Compassionate Friends presence, encircling the globe with support so desperately needed when the worst has happened.

[News & Information](#)

[Locate a Chapter](#)



The National Office is generously sponsored by Olga Kaplan in loving memory of Andrey Litvinenko

[Read Andrey's story](#)



6th International TCF Gathering
July 28-31, 2016 in Frankfurt/Main, Germany

[More Information](#)



Sponsor the Work of the National Office Through Your Memorial Gift
Weekly and Monthly sponsorships available

[More information](#)



Amazon will donate to The Compassionate Friends
Support us every time you shop

[Sign up now](#)

[Connect with us on Facebook](#)

[Find Support](#)

[Video](#)



Online Support Community
Connect, share and chat via our Online Support Community.
[Get Support](#)

[How you can help](#)



Find Support

- [Local Chapters](#)
- [About TCF Chapters](#)
- [Online Support](#)
- [To The Newly Bereaved](#)

Supporting TCF

- [Ways to Give](#)
- [Pledge Form](#)
- [Ways You Can Help](#)
- [How to Form a Chapter](#)

Donate

- [Donate to TCF](#)
- [Sponsor Us for a Week](#)
- [How Donations Are Used](#)
- [Donate to TCF Foundation](#)

More

- [Media Resources](#)
- [Facebook](#)
- [Twitter](#)
- [YouTube](#)

Preliminary Cost Estimate

Artwork	\$22,750.00
Hardscape	\$74,039.00
Landscape & Irrigation	\$41,588.00
Landscape Lighting	\$6,485.00
Subtotal	\$144,862.00
Contingency (10%)	<u>\$14,486.20</u>
TOTAL	\$159,348.20



MTFULLER
FUNCTIONAL ARTS

Mark Fuller
1080 Gator Trail
West Palm Beach, FL
33409

561.707.4688
mtfuller.id8@gmail.com
www.mtfuller.com

Public Art Installations

CoolPool - LULA, CRA, City of Lake Worth, FL (2014)
Juno Beach 9/11 Remembrance Memorial, Juno Beach, FL (2013)
Rainbow Swimming - Port Everglades Terminal 19, Broward County, FL (2013)
Stripe Squiggle Soup - Riverwalk, Bradenton, FL (2012)
Pinned Down By A Grape - Riverwalk, Bradenton, FL (2012)
Satellites Are Out Tonight - Riverwalk, Bradenton, FL (2012)
No Flying Strange Bananas - Riverwalk, Bradenton, FL (2012)
Walk This Way - Riverwalk, Bradenton, FL (2012)
Depend du Soleil - Florida Gulf Coast University, Ft. Myers, FL (2012)
Whatever You Say, Dear - Florida Gulf Coast University, Ft. Myers, FL (2012)
Anticipated Harvest - City of Boynton Beach, FL (2012)
My Lovely Distraction - Palm Beach County AIPP, West Palm Beach, Florida (2011)
Home of the Brave - City of Lauderhill, FL (2010)
09.11.01 Memorial - City of Palm Beach Gardens, Florida (2010)
Markers - Historic Mercer Cemetery, City of Trenton, NJ (2006)
The Tipping Points - Village of Royal Palm Beach, Florida (2009)
StentTower - Tenet Healthcare; Florida (2009)
Lotus Agikam - City of Lauderhill, Lauderhill, Florida (2009)
Cambier's Quilt - City of Naples, Naples, Florida (2009)
ArcSolar - Doubletree Hotel, Palm Beach Gardens, Florida (2008)
Triads - Store Inc, Palm Beach Gardens, Florida (2008)
The Last Pasture - Boynton Town Center, Boynton Beach, Florida (2008)
Waterhole #3 - Boynton Town Center, Boynton Beach, Florida (2008)
Eight Horses - The Sembler Company, St. Petersburg, Florida (2008)
Gimme Shelter - Pinellas County Cultural Arts Council, Seminole, FL (2008)
Light Swimming - Palm Beach County Arts Council, Delray Beach, Florida (2007)
The Fish - Channing Corporation, Palm Beach Gardens, Florida (2006)
The Obelisk - The Sembler Company, Palm Beach Gardens, Florida (2006)
Stack/45 - Legacy Place, Palm Beach Gardens, Florida (2006)
The Four Benches - The Sembler Company, Palm Beach Gardens, Florida (2006)
Buoyboards - South Street Seaport Museum, New York, NY (2006)
I'll Be Right Back - Skokowski Memorial Trust, City Hall, Palm Beach Gardens, (2005)
Butterfly Grove - PGA Commons, Palm Beach Gardens, Florida (2005)
Old 1051 - The Morris & Essex Lines, Newark Penn Station, NJDOT, Newark, NJ (2004)
Track 2; 1-9 - Pinellas County Cultural Arts Council, St. Petersburg, Florida (2004)
Magician's Birthday - Suntrust Bank, Palm Beach Gardens, Florida (2003)
WTC-9/11 Memorial - The City of Hoboken, New Jersey (2002)
Mood For Wind & Water I,II,III - Channing Corporation (2002)
Lizards, Fish, & Sailfish - I-95 Sound Barriers, FDOT, FL (2001)
Flock - The City of Mercer Island, Mercer Island, Washington (2001)
Square Peg- Round Hole - Interim Services, Seattle, WA (2000)
Tensegrity - Discovery Museum of the Desert, Palm Desert, California (1999)
Marlin Palms - The City of West Palm Beach, West Palm Beach, Florida (1995)
Fish Out Of Water - The City of West Palm Beach, West Palm Beach, Florida (1993)



MTFULLER
FUNCTIONAL ARTS

Mark Fuller
1080 Gator Trail
West Palm Beach, FL
33409

561.707.4688
mtfuller.id8@gmail.com
www.mtfuller.com

Mark Fuller / MTFuller

Mark Fuller (MTFuller) is an environmental graphic and industrial designer, and has been participating in the Public Art forum since 1992. He is a creator of dynamic site specific exterior public art installations for a wide variety of projects, and has been established in West Palm Beach, Florida since 1986. In his early years as a professional designer he served as Director of Graphics for a large urban planning firm before relocating to New York City as Senior Project Designer for world-renowned Lance Wyman of Lance Wyman, Ltd. (lancewyman.com) where he honed his design skills to a world-class level and gained invaluable experiences with top-shelf national and international clients and projects. His industrial design experience includes wayfinding systems, urban street furniture such as seating elements, bollards, lighting fixtures, tree grates, and information kiosks.

While the style of Mark's work is not characterized by a specific 'look'; it is highly stylized by his research into the unique function, architecture, environmental and cultural aspects that surround each project. As a result, the visual characteristics of Fuller's installations flex and change with an appropriate sensitivity for the project at hand. His works are site-specific, and typically laced with symbolic or abstract references that link the art solidly to its environment.

His projects have been referenced by a spokesperson for the National Endowment For The Arts as "a perfect example of what public art can be". His Art In Public Places installations have included kinetic constructions, compression-tension cable structures, and static free-standing elements. Recent works have explored the use of cutting edge high-technology and dichroic coatings. His installations have included solar-generated electric power, LED luminaries, and the recycling of various glass waste materials. With an interest to promote "green" and low carbon footprint ideology, Mark continues to move forward developing appropriate eco-conscious fabrication methods and techniques .

His immediate accessibility to, and experience with high-tech fabrication methods and finishing technology allow him to effectively determine appropriate production methods to accommodate budget, schedule, and function requirements. His projects often incorporate diverse fabrication methods, specialized epoxy-polyester hybrid coatings, and aero-space quality precision metal fabrications. With a 68,000 square foot production facility to provide him with state-of-the-art industrial lasers, water-jet cutting, CNC computerized machining, robotic welding, robotic brakes, Amada punch presses, powdercoating, and large format image reproduction, his ability to streamline the creative process from concept to reality is unequalled.



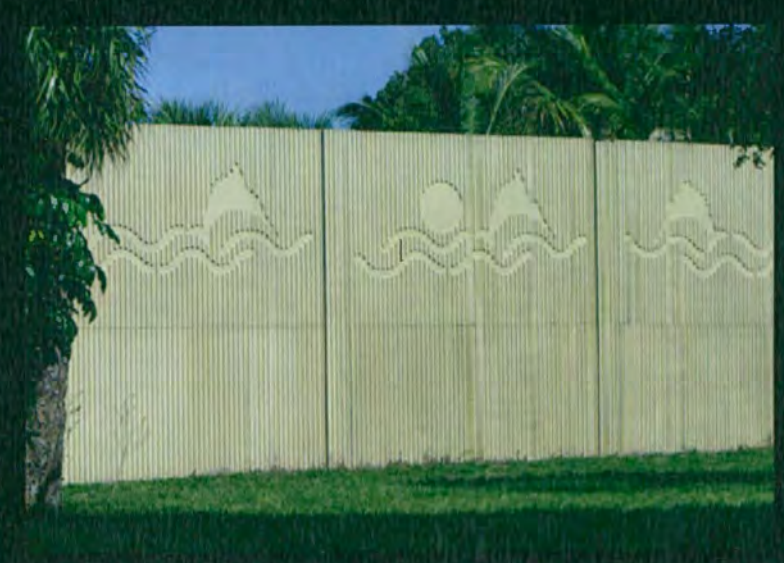

CITY OF
PALM BCH GDMS
ENVIRONMENTAL
PLANNING &
ZONING

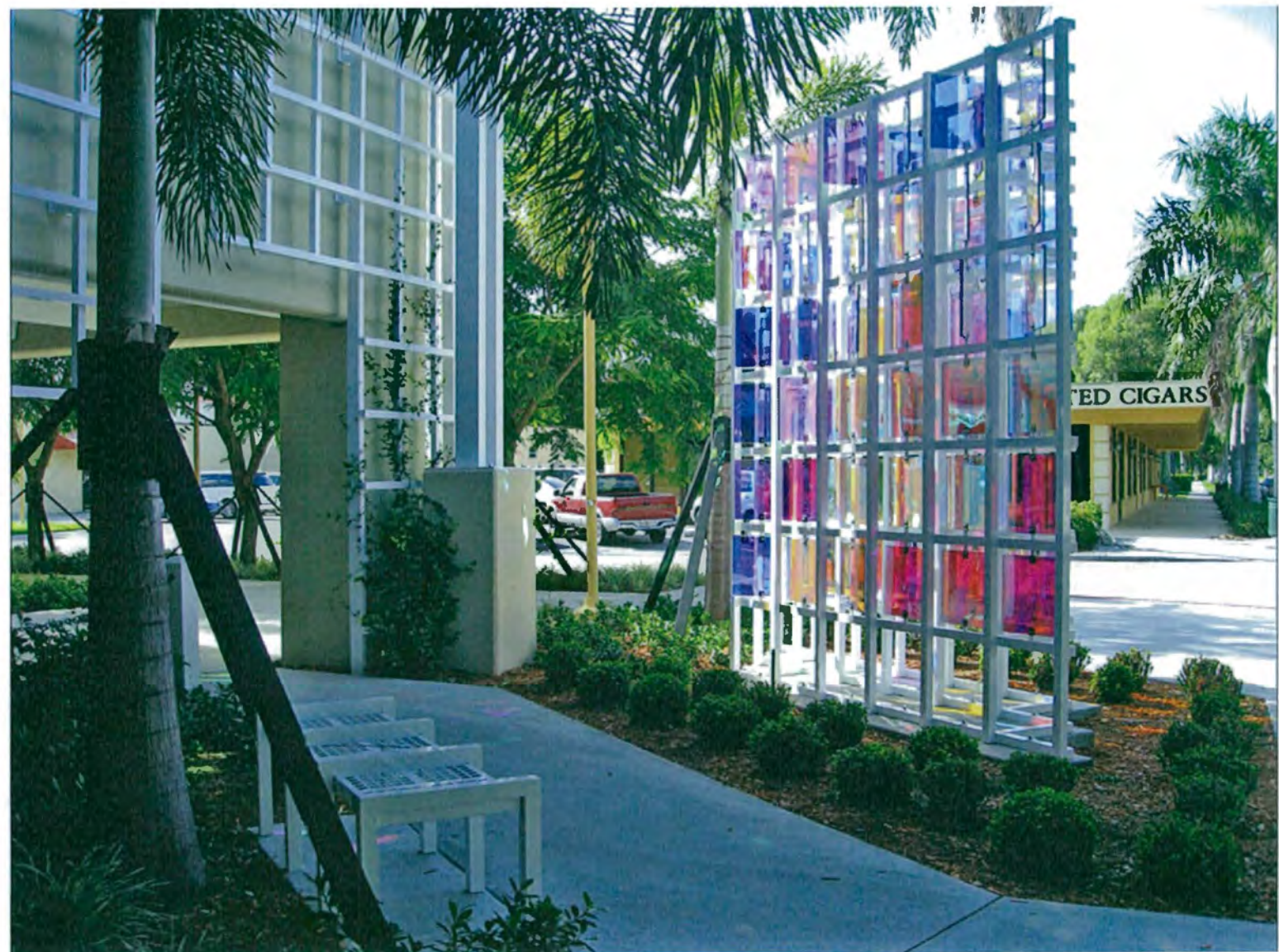















1
2
3
4
5
6
7
8
9
10
11
12
13
14
15
16
17
18
19
20
21
22
23
24
25
26
27
28
29
30
31
32
33
34
35
36
37
38
39
40
41
42
43
44
45
46

RESOLUTION 21, 2016

A RESOLUTION OF THE CITY COUNCIL OF THE CITY OF PALM BEACH GARDENS, FLORIDA APPROVING A CITY-INITIATED ART IN PUBLIC PLACES FOR THE COMPASSIONATE FRIENDS MEMORIAL GARDEN LOCATED AT THE CITY'S BURNS ROAD COMMUNITY CENTER, AS MORE PARTICULARLY DESCRIBED HEREIN; PROVIDING CONDITIONS OF APPROVAL; PROVIDING AN EFFECTIVE DATE; AND FOR OTHER PURPOSES.

WHEREAS, the City Council, as the governing body of the City of Palm Beach Gardens, Florida, pursuant to the authority in Chapter 163 and Chapter 166, *Florida Statutes*, and the City's Land Development Regulations, is authorized and empowered to consider petitions related to zoning and land development orders; and

WHEREAS, the City of Palm Beach Gardens Burns Road Community Center is currently zoned Planned Unit Development (PUD) Overlay with an underlying zoning designation of Public/Institutional (P/I) and has a future land-use designation of Recreation and Open Space (ROS); and

WHEREAS, the City adopted Ordinance 37, 2009, authorizing the expenditure of art impact funds for art and art maintenance to promote public art and the public art process in the City; and

WHEREAS, the Planning and Zoning Department has reviewed the application, has determined that it is sufficient and consistent with the City's Comprehensive Plan and Land Development Regulations, and has recommended approval; and

WHEREAS, the Art in Public Places (AIPP) Advisory Board reviewed the petition at its February 16, 2016, meeting and recommended approval of the petition (AIPP-16-01-000037) by a vote of 6 to 0; and

WHEREAS, the City Council has considered the evidence and testimony presented by the Applicant and other interested parties and the recommendations of the various City of Palm Beach Gardens reviewing agencies and staff; and

WHEREAS, the City Council deems approval of this Resolution to be in the best interest of the health, safety, and welfare of the residents and citizens of the City of Palm Beach Gardens and the public at large.

NOW, THEREFORE, BE IT RESOLVED BY THE CITY COUNCIL OF THE CITY OF PALM BEACH GARDENS, FLORIDA that:

1 **SECTION 1.** The foregoing recitals are hereby affirmed and ratified.
2

3 **SECTION 2.** The application for the City-initiated AIPP Compassionate Friends
4 Memorial Gardens at the City of Palm Beach Gardens Burns Road Community Center
5 is hereby APPROVED, subject to the conditions of approval contained herein, which are
6 in addition to the general requirements otherwise provided by resolution for the real
7 property described as follows:
8

9 LEGAL DESCRIPTION:

10
11 BURNS ROAD COMMUNITY CENTER CAMPUS, AS RECORDED IN PLAT BOOK 104,
12 PAGES 7 AND 8 IN THE OFFICIAL RECORDS OF PALM BEACH COUNTY, FLORIDA.
13

14 **SECTION 3.** This approval is subject to the following conditions, which shall be
15 the responsibility of and binding upon the Applicant, its successors, or assigns. All other
16 conditions from the development orders related to this project remain in full force and
17 effect:
18

- 19 1. The artwork shall be lighted, at a minimum, from dusk until midnight. (Planning
20 and Zoning Department)
- 21
22 2. The City shall be responsible for the maintenance of the memorial gardens and
23 work of art, which shall be utilized from the City's Art in Public Places
24 maintenance funds. (Planning and Zoning Department)
25

26 **SECTION 4.** This petition is approved subject to strict compliance with the
27 Exhibits listed below, which are attached hereto and made a part hereof as Exhibit "A":
28

- 29 1. Compassionate Friends Memorial Gardens Landscape Plan, prepared by *Cotleur*
30 & *Hearing*, dated March 9, 2016.
- 31
32 2. Compassionate Friends Memorial Project "Loving You, Loving Me" art details
33 prepared by Mark Fuller, date stamped January 5, 2016.
34

35 **SECTION 5.** All representations made by the Applicant or the Applicant's agent
36 at any public hearing regarding this application are specifically incorporated herein, and
37 this approval is granted subject to same.
38

39 **SECTION 6.** This Resolution shall become effective immediately upon adoption.
40
41
42
43
44
45
46

PASSED AND ADOPTED this _____ day of _____, 2016.

CITY OF PALM BEACH GARDENS, FLORIDA

BY: _____, Mayor

ATTEST:

BY: _____
Patricia Snider, CMC, City Clerk

APPROVED AS TO FORM AND
LEGAL SUFFICIENCY

BY: _____
R. Max Lohman, City Attorney

VOTE:

AYE NAY ABSENT

MAYOR	_____	_____	_____
VICE MAYOR	_____	_____	_____
COUNCILMEMBER	_____	_____	_____
COUNCILMEMBER	_____	_____	_____
COUNCILMEMBER	_____	_____	_____

EXHIBIT "A"

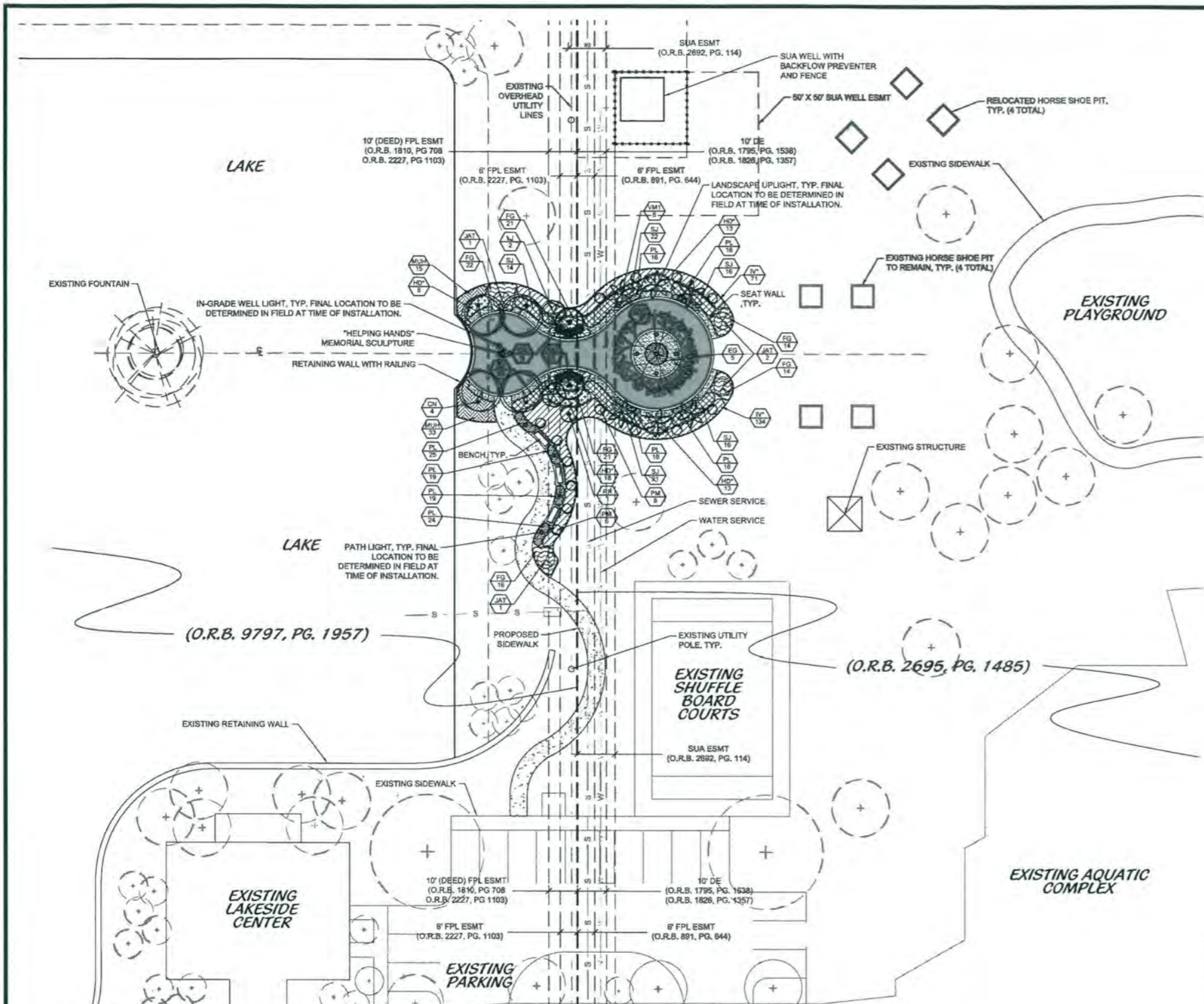

LANDSCAPE NOTES

ALL PLANT MATERIAL SHALL BE FLORIDA NUMBER 1 OR BETTER AS DEFINED BY THE DIVISION OF PLANT INDUSTRY GRASSES AND STANDARDS LATEST EDITION.

THE LANDSCAPE CONTRACTOR SHALL NOT MAKE ANY SUBSTITUTIONS OR CHANGES WITHOUT THE AUTHORIZATION OF THE CITY OF PALM BEACH GARDENS, THE OWNER AND THE LANDSCAPE ARCHITECT.

THE LANDSCAPE CONTRACTOR SHALL REVIEW THE PROJECT DRAINAGE AND UTILITY PLANS PRIOR TO CONSTRUCTION AND AVOID ALL CONFLICTS. THE LANDSCAPE CONTRACTOR SHALL VERIFY THE LOCATION OF ALL UNDERGROUND UTILITIES PRIOR TO COMMENCING WORK.

TREES SHALL BE POSITIONED TO AVOID CONFLICTS WITH SITE LIGHTING AND SIGNAGE.

ALL LANDSCAPE SHALL CONFORM TO THE REQUIREMENTS OF THE CITY OF PALM BEACH GARDENS LAND DEVELOPMENT REGULATIONS.

ALL ABOVE GROUND UTILITIES I.E. TRANSFORMERS, SWITCH BOARDS, AC CONDENSERS AND ALICE SHALL BE FULLY SCREENED FROM VIEW ON THREE SIDES WITH LANDSCAPING (EXCLUDING ANTENNAS). THE LANDSCAPING SHALL EXTEND ONE FOOT HIGHER THAN THE TALLEST POINT OF SAID EQUIPMENT AT THE TIME OF PLANTING.

ALL TREES SHALL BE LOCATED WITHIN A MINIMUM PLANTING BED WITH A MINIMUM OF TWO (2) FEET OF CLEARANCE TO THE EDGE OF THE BED.

SHADE TREES SHALL BE NO CLOSER THAN 15' FROM SUA UTILITIES UNLESS AN APPROVED 48" ROOT BARRIER IS PROVIDED. NO SHADE TREE WILL BE PERMITTED CLOSER THAN 10' FROM SUA UTILITIES.

PALM TREES SHALL BE NO CLOSER THAN 10' FROM SUA UTILITIES UNLESS AN APPROVED 48" ROOT BARRIER IS PROVIDED. NO PALM TREE WILL BE PERMITTED CLOSER THAN 7' FROM SUA UTILITIES.

ALL SOIL WITHIN NEW LANDSCAPE AREAS SHALL BE STENOCTAENIUM SECUNDARIUS "LORITAM" (ST AUGUSTINE SOIL), EXCEPT IN THE AREAS AROUND LAKES AND THE DRY RETENTION AREAS, WHERE BANJA SOO SHALL BE SPECIFIED.

TREES WITHIN PLANTING ISLANDS LESS THAN FIVE (5) FEET IN WIDTH SHALL BE LOCATED TO AVOID CONFLICTS WITH THE OVERHANGS OF VEHICLES.

TYPE D OR F RAISED CONCRETE CURBING SHALL BE PROVIDED AROUND ALL PLANTING ISLANDS WITHIN VEHICULAR USE AREAS.

TREES AT ENTRANCE WAYS AND WITHIN SIGHT TRIANGLES SHALL BE TRIMMED IN SUCH A FASHION TO MINIMIZE SITE VISIBILITY CONFLICTS. CLEAR VISIBILITY SHALL BE MAINTAINED BETWEEN 30 INCHES AND 7 FEET.

PLANTING ISLANDS WITHIN AND ADJACENT TO PARKING AREAS SHALL BE FREE OF LIMB ROCK AND OTHER FOREIGN MATERIALS TO A DEPTH OF 36". IF NECESSARY, RECYCLED PLANTING SOIL MIXTURE SHOULD BE USED TO REPLACE UNSUITABLE SOIL, WHICH IS EXCAVATED.

EARTH BERRIS SHALL NOT EXCEED 3" AND A SLOPE OF 4:1. ALL INTERIOR ISLANDS SHALL BE MOUNDING (SOUTH SLOPE) 1" HIGHER THAN THE CURB.

ALL AREAS SHALL BE FULLY IRRIGATED IN ACCORDANCE WITH THE REQUIREMENTS OF THE CITY OF PALM BEACH GARDENS.

THE IRRIGATION SYSTEM SHALL BE DESIGNED TO PROVIDE 100% OVERLAP COVERAGE TO ALL NEW LANDSCAPE AND SOIL AREAS.

THE IRRIGATION SYSTEM SHALL BE EQUIPPED WITH A RAIN SENSOR/OFF SWITCH IN ACCORDANCE WITH STATE AND LOCAL REQUIREMENTS.

THE LANDSCAPE CONTRACTOR SHALL BE RESPONSIBLE FOR ALL PERMITS FOR HIS/HER WORK.

NO VERTICAL CONSTRUCTION OR PLANTINGS WILL BE PLACED WITHIN THE 20-FOOT LAKE MAINTENANCE EASEMENT, WITH THE EXCEPTION OF THE AREAS WHERE A WAIVER HAS BEEN REQUESTED.

ALL LANDSCAPE SHALL CONFORM TO THE REQUIREMENTS OF THE CITY OF PALM BEACH GARDENS LAND DEVELOPMENT REGULATIONS. THE CITY OF PALM BEACH GARDENS CODE (LORS) SHALL GOVERN IN THE EVENT OF A CONFLICT.

ALL EXOTIC AND NUISANCE VEGETATION SHALL BE REMOVED FROM ON SITE.

ALL TREES AND LANDSCAPING WILL BE FIELD LOCATED TO AVOID CONFLICT WITH THE EXISTING UTILITY, LIGHT POLES AND DRAINAGE LINES.

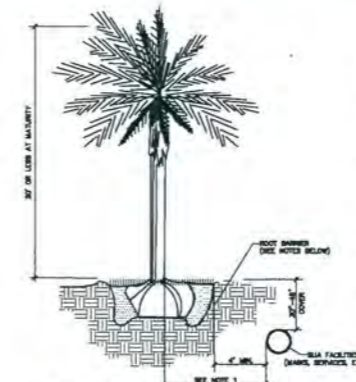

TYP. SMALL TREE OR PALM TREE WITH ROOT BARRIER

NOTES: (PLEASE REFER TO OTHER SPECIFICATIONS FOR ADDITIONAL REQUIREMENTS)

1. THE DISTANCE SHALL BE 10' MINIMUM WITH ROOT BARRIERS AND 12' MINIMUM IF NO ROOT BARRIERS IS USED.
2. ALL ROOT BARRIERS SHALL BE 4" MINIMUM FROM ALL EXISTING FACILITIES.
3. THE INSTALLATION OF ROOT BARRIERS SHALL BE COORDINATED WITH RESPECTIVE AND IMPACTED BY RESPECTIVE PRIOR TO INSTALLATION. ALL ROOT BARRIERS SHALL EXTEND UP TO FINISHED GRADE.
4. ROOT BARRIERS SHALL BE MINIMUM 3/4" DEEP. APPROVED PRODUCTS INCLUDE "DEEP ROOT" AND "ROOT BARRIER". FLEXIBLE BARRIERS SHALL BE 3/4" PANELS MANUFACTURED BY BROWNE.
5. ALL ROOT BARRIERS SHALL BE INSTALLED IN ACCORDANCE WITH MANUFACTURER'S WRITTEN INSTRUCTIONS.

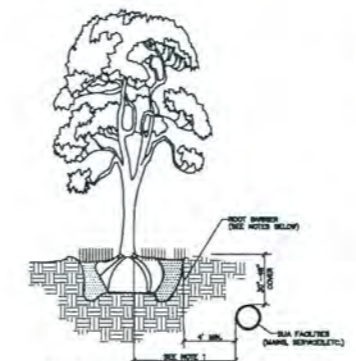

TYP. CANOPY TREE, LARGE OR EXOTIC PALM TREE WITH ROOT BARRIER

NOTES: (PLEASE REFER TO OTHER SPECIFICATIONS FOR ADDITIONAL REQUIREMENTS)

1. THE DISTANCE SHALL BE 10' MINIMUM WITH ROOT BARRIERS AND 12' MINIMUM IF NO ROOT BARRIERS IS USED.
2. ALL ROOT BARRIERS SHALL BE 4" MINIMUM FROM ALL EXISTING FACILITIES.
3. THE INSTALLATION OF ROOT BARRIERS SHALL BE COORDINATED WITH RESPECTIVE AND IMPACTED BY RESPECTIVE PRIOR TO INSTALLATION. ALL ROOT BARRIERS SHALL EXTEND UP TO FINISHED GRADE.
4. ROOT BARRIERS SHALL BE MINIMUM 3/4" DEEP. APPROVED PRODUCTS INCLUDE "DEEP ROOT" AND "ROOT BARRIER". FLEXIBLE BARRIERS SHALL BE 3/4" PANELS MANUFACTURED BY BROWNE.
5. ALL ROOT BARRIERS SHALL BE INSTALLED IN ACCORDANCE WITH MANUFACTURER'S WRITTEN INSTRUCTIONS.

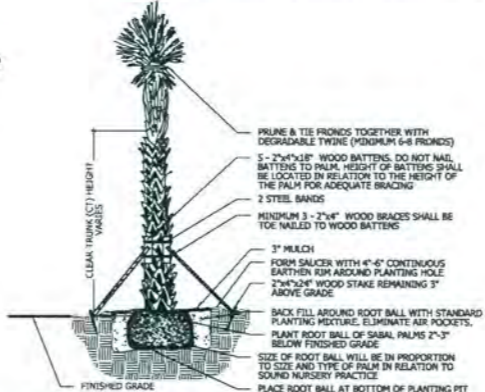
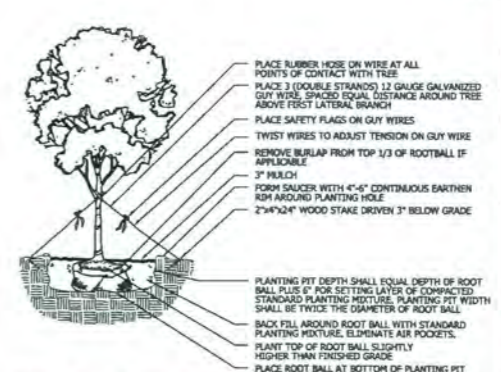

PLANT LIST

TREES	QTY	BOTANICAL NAME	COMMON NAME	CONT	SIZE	SPACE	REMARKS
CN	4	COCOS NUCIFERA 'MAYPAN'	COCONUT PALM	N.A.	N.A.	10'-16" GW	FULL CANOPY, CURVED TRUNK
JAT	4	JATROPHA INTEGRERIMA	JATROPHA	25 gal	1.5" Cal	4'-5" HT, 3' SPRD, LIMB UP 2'	FULL & THICK, MULTI-STEM, FLORIDA FANCY
LJ	2	LIGUSTRUM JAPONICUM	JAPANESE PRIVET	30 gal	3 TRK MIN., 1"-2" CAL. EA.	6' HT., 6' SPD.	MULTI, FULL, FLORIDA FANCY
PR	1	PHOENIX ROBELENI	PYGMY DATE PALM	N.A.	N.A.	5' O.A., 5' SPRD	MULTI-TRUNK, FULL CANOPY, 3 TRUNK MIN.
QV*	1	QUERCUS VIRGINIANA	LIVE OAK	N.A.	6" CAL.	20' HT. X 7' SPRD.	FULL CANOPY, 6" C.T. MIN.
AK3	2	VETICHA MERRILLII-ADONIDIA	CHRISTMAS PALM	N.A.	N.A.	10' O.A.	FULL CANOPY, TRIPLE TRUNK
VM1	6	VETICHA MONTGOMERYANA	MONTGOMERY PALM	N.A.	N.A.	14'-16" O.A.	SINGLE TRUNK, FULL CANOPY. MATCHED
SHRUBS	QTY <th>BOTANICAL NAME</th> <th>COMMON NAME</th> <th>CONT</th> <th>SIZE</th> <th>SPACE</th> <th>REMARKS</th>	BOTANICAL NAME	COMMON NAME	CONT	SIZE	SPACE	REMARKS
CA	6	CRINUM AUGUSTUM	QUEEN EMMA CRINUM LILY	15 gal	3" X 3"	A.S.	FULL & THICK
PM	14	PODOCARPUS MAXII ~	PODOCARPUS COLUMN	45 gal	7"-8" O.A X 3"	A.S.	FULL & THICK, COLUMNAR, MATCHED.
GROUND COVERS	QTY <th>BOTANICAL NAME</th> <th>COMMON NAME</th> <th>CONT</th> <th>SIZE</th> <th>SPACE</th> <th>REMARKS</th>	BOTANICAL NAME	COMMON NAME	CONT	SIZE	SPACE	REMARKS
EG	5	EPIPREMNUM AUREUM	GOLDEN POTHOS	1 gal.	15" X 15"	3" O.C.	FULL HEAD
FG	108	FICUS MACROPHYLLA 'GREEN ISLAND'	GREEN ISLAND FIGUS	3 gal	12" x 12"	2" O.C.	FULL & THICK
HD*	52	HAMELIA PATENS 'COMPACTA' ~	DWARF FIREBUSH	3 gal	24" X 24"	2" O.C.	FULL & THICK, FLORIDA NATIVE VARIETY
IV*	205	ILEX VOMITORIA 'SHILLINGS DWARF' ~	DWARF YALPON HOLLY	3 gal	15" X 15"	2" O.C.	FULL & THICK
MUH	48	MUHLENBERGIA CAPILLARIS ~	PINK MUHLY GRASS	3 gal	24" X 24"	2" O.C.	FULL & THICK
PL	151	PENTAS LANCOLATA	DWARF RED PENTAS	1 gal	6" x 6"	12" O.C.	RED FLOWERS
SJ	104	STACHYTARPHETA JAMAICENSIS	BLUE PORTERWEED	3 gal.	12" x 12"	24" O.C.	FULL & THICK

LEGEND

- IN GRADE WELL LIGHT
- UPLIGHT
- PATH LIGHT



LANDSCAPE PLAN

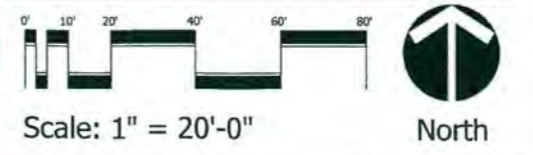

Cotleur & Hearing
Landscape Architects
Land Planners
Environmental Consultants
1934 Commerce Lane
Suite 1
Jupiter, Florida 33458
561.747.6336 • Fax 747.1377
www.cotleurhearing.com
Lic# LC-C000239

**COMPASSIONATE FRIENDS
MEMORIAL GARDEN**
Palm Beach Gardens, Florida

DESIGNED: DEH
DRAWN: MCR
APPROVED: DEH
JOB NUMBER: 151107
DATE: 01-04-16
REVISIONS: 02-09-16, 03-09-16
March 09, 2016 2:02:43 pm
Drawing: MEMORIAL_GARDEN.DWG
SHEET 1 OF 1
© COTLEUR & HEARING, INC.
These drawings are the property of the architect and are not to be used for reproduction or in other projects without the written consent of the architect. Immediately upon any discontinuation of the architect.

Compassionate Friends Memorial Project

Loving You, Loving Me

Powdercoated aluminum, polished stainless steel



MARK FULLER
FUNCTIONAL ARTS

COPYRIGHT 2015 MFFULLER / MARK FULLER - ALL RIGHTS RESERVED

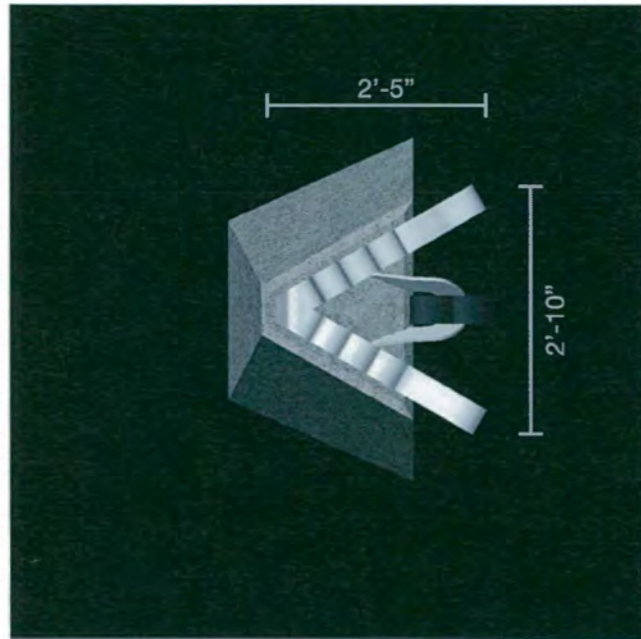

TOP VIEW

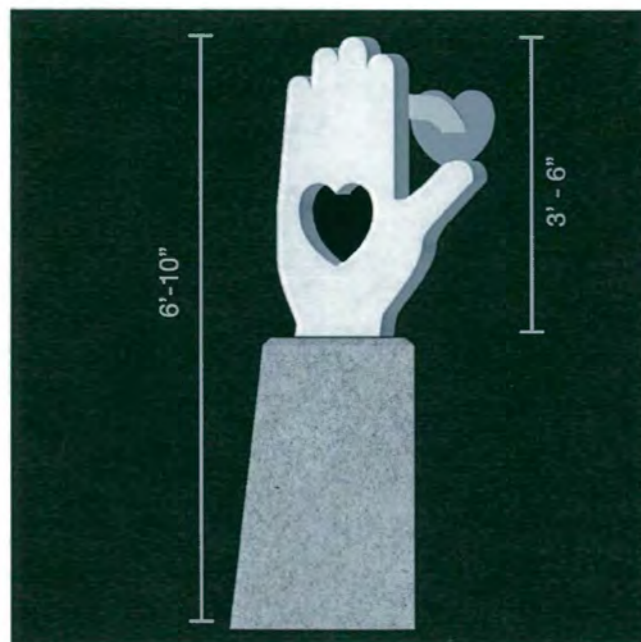

SIDE VIEW



END VIEW

